

Zykon-Panel anchor FZP II T Tergo+

The specialist for thin fibre cement façade panels by Equitone.

2

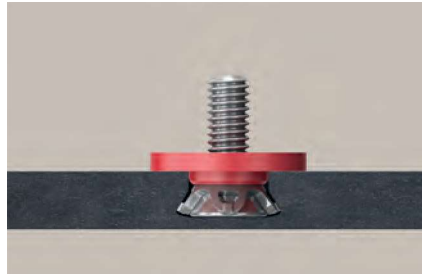

Tergo+ in Equitone fibre cement boards

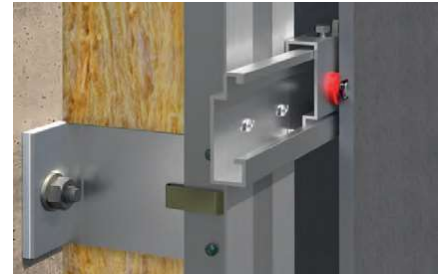

Façade cross-section with Tergo+ anchor

Applications

- Exterior façades
- Interior façades
- Façade reveals

Certificates



Advantages

- The anchors' short geometry allows it to be used in thin panels with a thickness greater than 8 mm.
- The fixing of the undercut anchor is not visible on the exposed side, creating a visually attractive and consistent façade surface.
- The adapted shape of the undercut anchor ensures a positive-locking attachment free from expansion pressure in a conical undercut drill hole.
- Setting the anchor using undercut technology allows the user to always select the optimal structural position in the façade panel. This greatly reduces panel deflection.
- The positive-locking anchor is free from expansion pressure and is attached at the fifth point in a structurally optimised location. This provides much better holding force than commonly available systems and allows for the use of large-format panels.

Functioning

- Use dry drilling with a diamond drill bit - first cylindrical, then conical - to drill an undercut hole.
- When the undercut anchor is installed, an optimal, positive-locking connection is created between the expanding part and the drill hole.
- The anchor is installed flush to the absolute anchoring depth. After the anchor is set, the spacer washer will be in full contact with the surface of the material.

Building materials

- Equitone fibre cement ($\geq 8\text{mm}$)

Installation FZP II T Tergo+

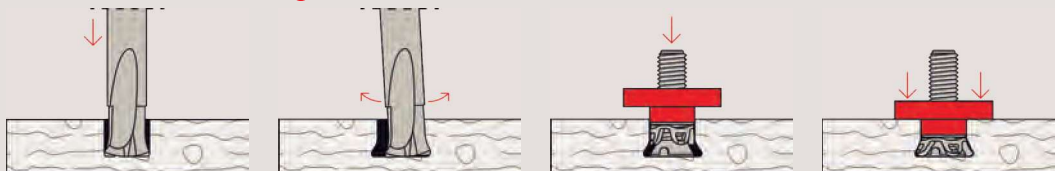



Cahir Castle · Tipperary · Ireland

Technical data



Tergo+ 11 x 6

Tergo+ 11 x 8

Tergo+ 11 x 10

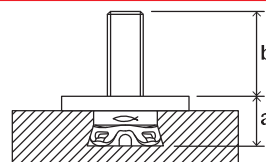

Item	Item No.	Approval DIBt	Installed anchor length a [mm]	Anchorage depth h_{ef} [mm]	Projection length b [mm]	Thread \varnothing x length [mm]	cylindrical diameter [mm]	Undercut diameter [mm]	Min. panel thickness [mm]	Sleeve material	Sales unit [pcs]
Tergo+ 11 x 6 M6/T/10 PA	532641	●	8.5	6	10		11	13.5	8	Polyamide PA6	250
Tergo+ 11 x 6 M6/T/13 PA	532642	●	8.5	6	13		11	13.5	8	Polyamide PA6	250
Tergo+ 11 x 8 M6/T/10 PA	537974	●	10.5	8	10		11	13.5	12	Polyamide PA6	250
Tergo+ 11 x 8 M6/T/13 PA	537975	●	10.5	8	13		11	13.5	12	Polyamide PA6	250
Tergo+ 11 x 10 M6/T/9 PA	532643	●	12.5	10	9		11	13.5	14	Polyamide PA6	250

These anchors are supplied with M6 locknuts, which have to be used for the installation of the clasps.